



SIDE HINGED GARAGE DOORS - SHD

PRICELIST
valid from 11/15/2023

Contents

General Information	3
Layouts	4
Door Models	5
Luxury Door Models	6
Frames & Thresholds	7
Options	
Handles & Locks	8
Windows & Glazing	10
Hardware	12
Customised design options	14
Frame, Handing & Opening Options	15
Site Survey Form	17
Side Hinged Door Order Form	18
Notes	19



Ryterna UK Ltd.

phone: 020 3239 9156

e-mail: sales@ryterna.co.uk

fax: 01923 606 610

www.ryternagaragedoors.co.uk

Registered in England & Wales

Reg. No. 07972953

VAT No. GB 135039923



IMPORTANT INFORMATION

All doors are made to measure.

Overall frame sizes are indicated in the tables of price-list.

To obtain the price please check corresponding or intermediate width and height.

For door sizes exceeding price-list limits ask the manufacturer.

Please note that depicted colours are for guidance only. Use official support materials for accurate colour.



Sales and Delivery terms

1. Orders: to be sent by e-mail or fax. All given data must be clear and readable. All required information: width, height, headroom, side-room, track system, design, colours, etc. must be indicated. Correct orders will be confirmed within 48 hours. The order confirmation should be checked and corrected if necessary. Orders cancelled later than 48 hours after the order confirmation was sent will be charged for the value of goods used for production.

2. Delivery time: 3-4 weeks from order confirmation date for standard doors, and 4-6 weeks - for non standard doors (with wicket door, FV sections, custom coating). Delivery term may be postponed in case of Force Majeure circumstances or any other reasons caused by third parties. The customer will be informed in advance.

3. Delivery: to be delivered to the dealer's warehouse. Delivery to dealer's warehouse is free of charge. Deliveries to other addresses will be charged separately. At the unloading location must be an adult person capable to assist driver to unload and authorised to sign for the delivery.

4. Transportation: dealer's warehouse address on UK Mainland - free of charge (except London and Scotland).

5. Prices: are subject to be changed within 30 days notice.

Prices are in British Pounds and do not include VAT, other taxes.

6. Payment term: 30 days from the invoice date or in advance if not agreed otherwise. Manufacturer may charge average bank interest if the invoice was not paid in due time. There will be no further orders released if there are outstanding invoices.

7. Reclamation: damages or defected goods should be claimed in 5 working days after delivery. Damages made during the transportation should be fixed at unloading. Report must be made before installation if door parts are damaged during transportation, have scratches or dents or missing parts. Manufacturer is not responsible for damages made by negligent handling, unprofessional fitting or inappropriate storage.

8. Manufacturer is responsible to supply defected parts or products free of charge. The manufacturer is not obliged to cover replacement costs. No other costs related to replacing of defective parts may be charged if not accepted by manufacturer.

9. Deviations in colour are to be expected due to the use of different base materials, such as aluminium, steel, plastic, textures, as well as varying productions process, etc. Despite the use of the best coating systems, colour deviations cannot be ruled out.

Ryterna Warranty Terms

Ryterna as manufacturer grants warranty covering safe and reliable function of garage doors for a period:

10 years – safe and reliable operation

2 years – locks, stays and hinges, paintwork

Normal wear and tear are not accepted as material defect.

No warranty against condensation inside of acrylic/polycarbonate double glazing units.

Different parts painted the same colour may look unlike due to different basis materials and surface structure.

Requirements:

Warranty claims are only applicable in the country where door was purchased. The door must be purchased through our authorised distributor.

The warranty only covers the contract object.

The fully completed product warranty card together with the receipt of purchase substantiate your right to claim under warranty.

Obligations:

During warranty period we undertake to rectify any and all defects to Ryterna product, which can be provided to be attributed to a material or manufacturing fault.

We pledge at our discretion to either exchange the defective merchandise for faultless merchandise, repair it or allow a reduction in price.

We do not accept costs of for dismantling and installation nor for carriage.

Ryterna is not liable for direct damage, like loss of profit or earning during repair or service period.

The warranty does not cover damage caused through:

Improper installation and negligent care or maintenance.

Industrial use.

Improper initial and subsequent operation.

Negligent or wanton destruction.

External influence such as: fire, water, salts, alkaline or acid solutions or any other abnormal environmental influence.

Mechanical damage through improper transportation and installation or through falling or hitting objects.

Improper use of surface cleaning or protection treatments.

Repair by nonqualified persons.

Using non Ryterna parts without written approval of the manufacturer.

Removal of product label or making it unidentifiable.

Application of additional non approved weights or infills.

Failure to remove protective film or packaging provided with product where applicable.

Small dents, scratches or paint imperfection if they are not visible from 3 metres distance are not considered as warranty issue.

Technical specifications for 3 x 2.25 m SHD door	
Air permeability	Class 3
Resistance to water penetration	Class 3
Resistance to wind load	Class 5
Thermal transmittance - U-value	2.2 W/(m ² ·K)

Layouts

All doors are insulated, made to measure & factory framed

Marking of SHD



SH1 - doors with single leaf



SH2 - doors with 1+½ or 2 leaves



Layout Options (for doors over 2.5 metre wide or 2.5 metre high re. Vertical & Chevron layout consult manufacturer)

Rib

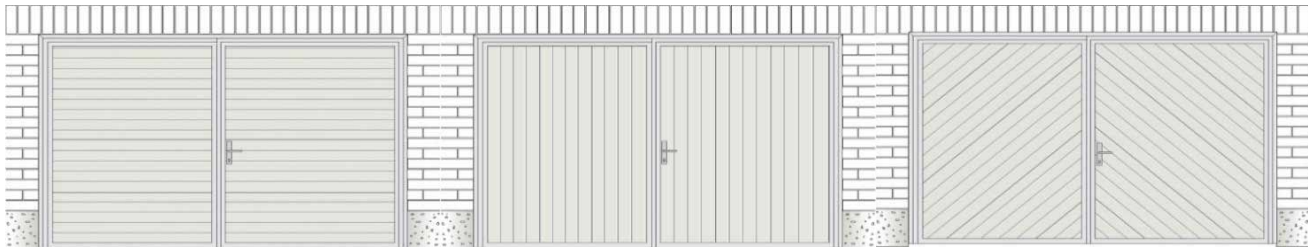

Midrib

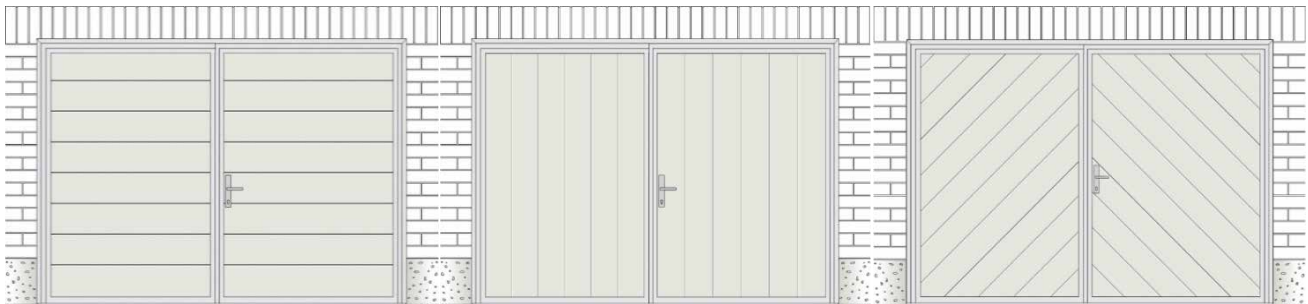

Flush



Traditional



Different panel designs and colours can be combined on one door
For different design panel mix add £150

Door models

Standard specifications

- Horizontal layout
- Threshold S5A
- Door stays
- 50/50 split (ex. Georgian design)
- 60mm x 80mm rebated frame
- Aluminium, black or white lever handle set
- Euro profile single point lock with 5 keys
- Integral locking shut-bolts to fixed leaf
- Leaf's & frame the same colour
- Measuring & ordering OFS only

Design & Standard Colours

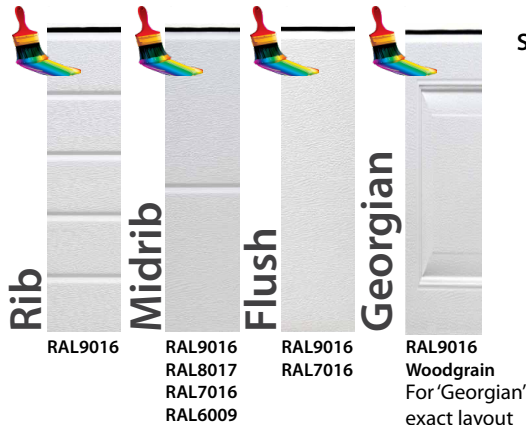

Woodgrain surfaces



Custom colours:
Standard gloss 20%
Max gloss up to 40%

Standard colours

SH1	H/W	900	1300
	2150	1183	1418
	2250	1382	1426

Custom RAL & Wood Image Colours

H/W	900	1300
2150	1279	1556
2250	1483	1572

Midrib Slick Wood



Golden oak
Old oak
Light oak
Winchester oak
Dark oak
Rosewood

SH2

H/W	1500	1750	2000	2250	2500	2750	3000
2125	2079	2296	2450	2642	2732	2820	2962
2250	2152	2371	2525	2720	2810	2913	3043
2400	2303	2525	2681	2837	2944	3036	3130
2750	2431	2631	2804	2991	3152	3274	3398
3000	2552	2792	3007	3249	3439	3602	3753

H/W	1500	1750	2000	2250	2500	2750	3000
2125	2238	2482	2663	2881	2998	3112	3281
2250	2321	2568	2750	2973	3091	3222	3381
2400	2483	2735	2921	3107	3244	3366	3490
2750	2637	2872	3079	3300	3496	3652	3811
3000	2777	3055	3307	3587	3814	4015	4203

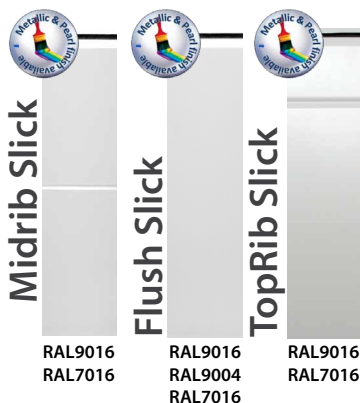

Smooth surfaces



Custom colours:
Standard gloss 20%
Max gloss up to 40%



Custom colours:
Standard gloss 20%
Max gloss up to 40%

Standard colours

SH1	H/W	900	1300
	2150	1248	1482
	2250	1447	1490

Custom RAL colours & Slick + panels

H/W	900	1300
2150	1363	1648
2250	1569	1666

SH2

H/W	1500	1750	2000	2250	2500	2750	3000
2125	2360	2552	2731	2962	3051	3166	3308
2250	2433	2627	2820	3052	3156	3260	3402
2400	2585	2779	2976	3184	3290	3395	3513
2750	2763	2976	3175	3426	3612	3735	3870
3000	2871	3163	3455	3709	3949	4114	4277

H/W	1500	1750	2000	2250	2500	2750	3000
2125	2551	2775	2986	3249	3370	3517	3691
2250	2636	2863	3090	3356	3494	3631	3807
2400	2801	3031	3264	3508	3650	3791	3945
2750	3011	3265	3505	3797	4025	4189	4365
3000	3141	3478	3815	4114	4399	4609	4817

Flush Slick+



Stainless Steel
Old Copper
Metallic Anthracite grey

Luxury door models

Traditional

'Traditional' design:

Glazed panel: acrylic scratch-proof.

'Cross' or BS double glazing.

Clear or Obscure glass.

Rib, Midrib, Flush woodgrain design panels.

Horizontal layout.

Standard colour RAL9016.



Cross glazing

BS glazing

Standard colours

SH1	H/W	900	1300
	2150	1494	1627
	2250	1591	1635

Custom RAL colours

H/W	900	1300
2150	1590	1765
2250	1692	1781

SH2	H/W	1500	1750	2000	2250	2500	2750	3000
	2125	2603	2770	2936	3178	3307	3460	3601
	2250	2663	2831	3011	3295	3411	3502	3696
	2400	2853	3023	3193	3438	3545	3625	3781
	2750	3020	3271	3507	3797	4086	4196	4369
	3000	3165	3483	3788	4080	4333	4509	4687

H/W	1500	1750	2000	2250	2500	2750	3000
2125	2762	2956	3149	3417	3573	3752	3920
2250	2832	3028	3236	3548	3692	3811	4034
2400	3033	3233	3433	3708	3845	3955	4141
2750	3226	3512	3782	4106	4430	4574	4782
3000	3390	3746	4088	4418	4708	4922	5137

Diamond

'Diamond' design:

8 stainless steel 15x15 cm double glazed windows.

Matt, obscure, clear glazing included.

Panel combination: Rib & Flush woodgrain (*custom combinations available*).

Chevron layout.

Standard colour RAL9016.



Standard colours

SH2	H/W	2000	2250	2500	2750	3000
	2125	4298	4533	4623	4712	4853
	2250	4375	4770	4860	4964	5094
	2400	4530	4887	4993	5086	5180

Custom RAL colours

H/W	2000	2250	2500	2750	3000
2125	4511	4772	4889	5004	5172
2250	4600	5023	5141	5273	5432
2400	4770	5157	5293	5416	5540



Custom colours:

Standard gloss 20%

Max gloss up to 40%

Modern

'Modern' design:

Matt, obscure, clear glazing included.

Painted central FV panel. Can be door or different colour.

Flush Slick design panels.

Vertical layout.

Custom colours incl. Slick+ panels.

Pull H-90R 800 mm stainless steel handle on active leaf.

Any RAL colour including metallic finish.



Custom RAL colours

SH2	H/W	2000	2250	2500	2750	3000
	2125	4338	4613	4738	4891	5072
	2250	4446	4725	4868	5012	5195
	2400	4629	4885	5031	5178	5338



Custom colours:

Standard gloss 20%

Max gloss up to 40%

Frames & Thresholds

Insulated Side hinged garage doors are made of 40mm thick double steel skin panels filled with freon-free PU foam.

All doors come with steel frame.

Doors are made to measure. Ordering and pricing - overall frame sizes (OFS).

Door split 50/50 by default or custom in reasonable proportions.

Max 3000 mm wide and 3000 mm high. For bigger sizes ask manufacturer. Max leaf width for SH2 - 1450 mm.

For doors less than 2 metres wide - ask for available layout.

1 leaf (SH1) door max 1300mm wide.

1.5 leaf doors for openings 1100 - 1800 mm wide.

2 leaf's doors for openings above 1800 mm wide.



Frames

Standard

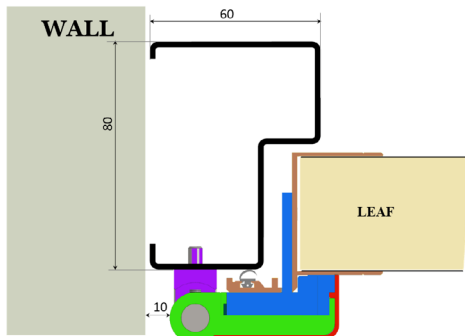

With moulding

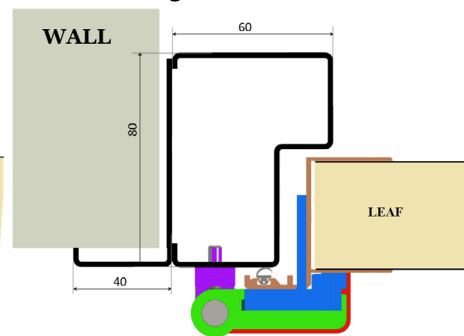

Tubular frame (recommended for back fix)

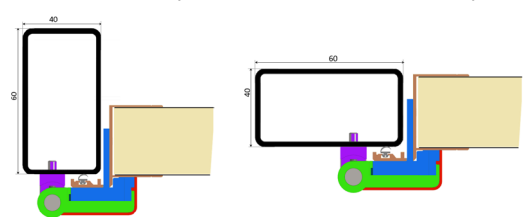

Standard tube sizes :
40 x 60 / 80 / 100 mm
For tubular frame add **£155**

Thresholds

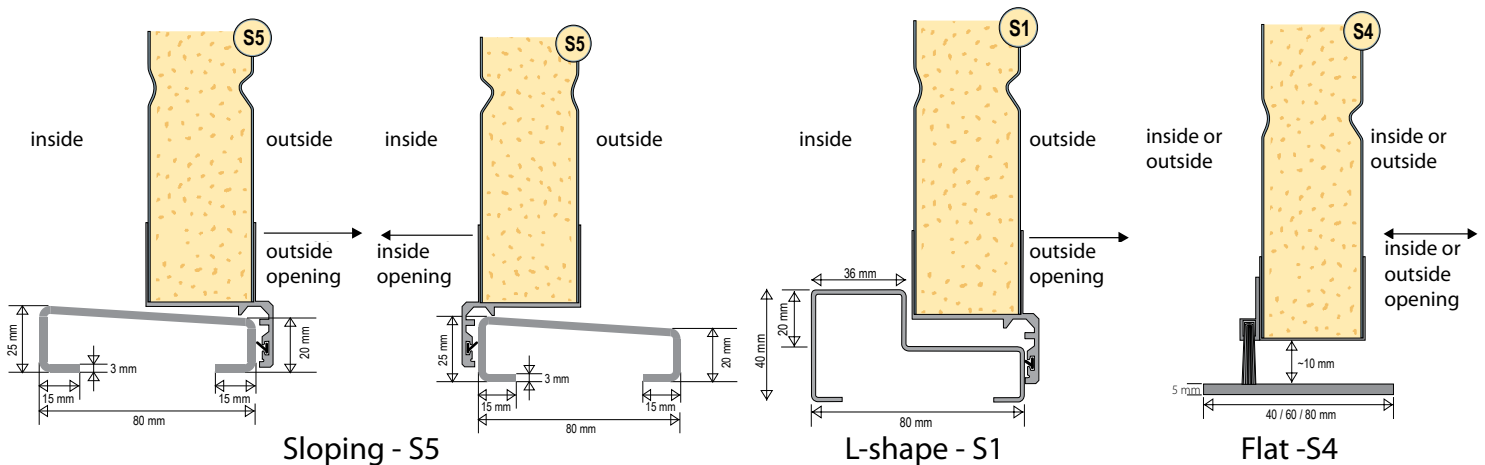

Type	Shape	Features	Price	
			SH2	SH1
S5A	Sloping	Flat-packed on site assembly frame. Universal.	-	-
S5	Sloping	One-piece welded. Universal.	£160	-
S1	L - shape	One-piece welded. Not suitable for cars.	£160	-
S4A	Flat	Flat-packed on site assembly frame. Water penetration is likely.	-	-
S4	Flat	One-piece welded. Water penetration is likely.	£160	-

Doors with OFS above 2.5 x 2.3 metres with flat packed frame only.

Raised threshold

£155

For sloping or flood risk driveways

Standard option +30 mm increase

For other options consult manufacturer

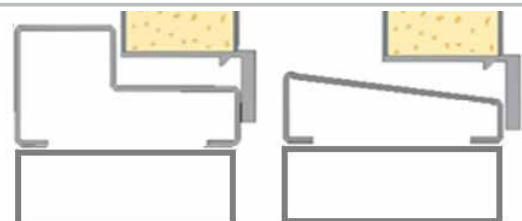

Handles



Standard handle and escutcheon plate colours.
Default door colour and handle colour combinations:

- **white** handle for white doors,
- **black** handle for colour and wood image doors,
- **aluminium** handle -upon request.

Please specify if different.

Standard option

Hinges



For SH2 only.
SH1 - stainless steel hinges with springs.
Adjustable in 2 directions aluminium cast hinges.
Standard colours: white, black, aluminium to match handle colour.
For hinges painted custom colour add £256.

Standard option

Door Stays



Keep door leaf fixed in open position
Adjustable leaf opening angle 90 - 135 degrees
Standard option

Standard option

Hinge Bolts



Security option - extra strength on hinge side of door leaf.

Standard option

Espagnolette Lock

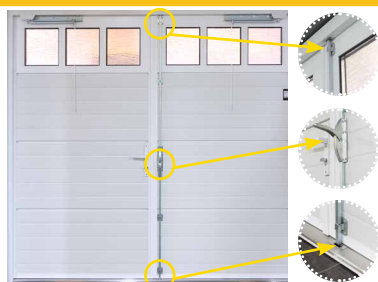

Convenience option - for fast second leaf fixation.
Added convenience for rapid fixed leaf operation, one lever on the back of the door.
Standard option - two integral shoot-bolts on second leaf.

£160

3 Point Lock



Increased security option, locks door in 3 places.
Minimum door height 1900mm
KFV BS2300 multi point lock with two steel round bolts. Up to RC2 security class according EN1627-1630
Equipped with Soft lock latch for whisper-quiet closing comfort without maintenance expenditure.
Recommended for doors over 2.3 m high

£290

Antipanic Lock



Stainless steel
Knob - outside
Lever handle - inside

£217

Not compatible with 3 point lock.

Lock ASSA Modular 565



Security option - high security lock.
Chrome plated handle and lock plate cover.

£234

Not compatible with 3 point lock.

Key Cylinder with Thumb-Turn



Convenience option - fast door locking from inside without key.

£22

Fixed knob



Fixed knob handle

Possible door colour and handle colour combinations:

- white handle for white doors,
- black handle for colour and wood image doors,
- aluminium handle -upon request.

Please specify if different.

£34

Brushed stainless steel handles

Pull handles

Round bar

H90R-500 (H 500 mm) **£181**

H90R-800 (H 800 mm) **£202**

H90R-1200 (H 1200 mm) **£224**

H90R-1400 (H 1400 mm) **£245**

H90R-1800 (H 1800 mm) **£266**

Square bar

H90S-500 (H 500 mm) **£181**

H90S-800 (H 800 mm) **£202**

H90S-1200 (H 1200 mm) **£224**

H90S-1400 (H 1400 mm) **£245**

H90S-1800 (H 1800 mm) **£266**

Lever handles



HLS 02



HLS 03



HLS 04



HLS 05



HLS 06



HLS 12

Handle & escutcheon design	Outside only	Outside + Inside
HLS 02 - HLS 06	£170	£309
HLS 12	£80	£144



Self locking. Opening from outside with the key only.
Pull handles compatible with standard, antipanic & 3 point locks.



All prices are per 1 handle.

Round Stainless Steel Windows



Single glazed with safety glass

Ø15cm - **£145** clear, **£169** matt/tinted, **£182** obscure*

Ø23cm - **£169** clear, **£194** matt/tinted, **£207** obscure*

Ø31cm - **£193** clear, **£216** matt/tinted, **£230** obscure*

For custom colour frame add £37 per window

For 'Golden Oak' colour frame add £72 per window

Outside only



Square Stainless Steel Windows

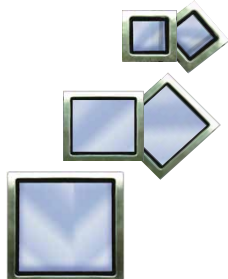

Double glazed with safety glass

15x15cm - **£145** clear, **£169** matt/tinted, **£182** obscure*

23x23cm - **£169** clear, **£194** matt/tinted, **£207** obscure*

31x31cm - **£193** clear, **£230** matt/tinted, **£235** obscure*

For custom colour frame add £37 per window

For 'Golden Oak' colour frame add £72 per window

Outside only



Oblong Stainless Steel Windows



Double glazed with safety glass

80x15cm - **£290** clear, **£338** matt/tinted, **£350** obscure*

In vertical position for Side Sliding Doors only

For custom colour frame add £37 per window

For 'Golden Oak' colour frame add £72 per window

Outside only



PVC Windows

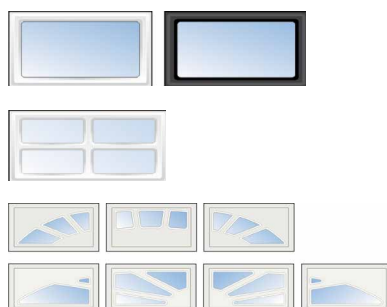

Scratch proof acrylic double glazing

49x32cm - **£86** clear, **£105** matt, **£126** obscure

49x32cm with 'Cross' insert - **£104** clear, **£123** matt, **£144** obscure

49x32cm with 'Sunrise' insert- **£110** clear, **£129** matt, **£150** obscure

For custom colour frame add £37 per window

Outside only



Glazing Options

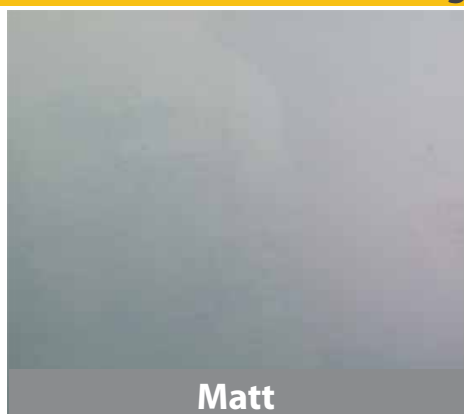

Matt



Obscure

* - clear, matt/tinted - safety glass, obscure - acrylic; square -double glazing, round - single glazing

Full Vision Double-Glazed Panels

FV panels painted custom colour. The door colour or different.

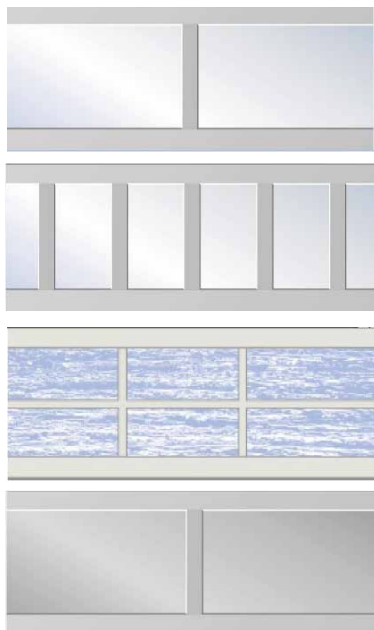

FV-standard

Clear scratch-proof acrylic double glazing
Matt or tinted acrylic double glazing
Obscure double glazing

FV- BS (with dense mullions)

Clear scratch-proof acrylic double glazing
Matt acrylic double glazing
Obscure acrylic double glazing

FV- cross

Clear scratch-proof acrylic double glazing
Obscure acrylic double glazing

FV- infill

Panel with custom painted filling - **£140**
Double skin insulated sandwich filling instead of glazing

Safety glass glazing options

Single glazing (add to any of panel types above) - **£46**

Double glazing (add to any of panel types above) - **£72**

For safety glass glazing and door size consult manufacturer



All prices are for 1 panel per 1 length metre



Please note that manufacturers cannot offer any warranty against condensation inside of acrylic or polycarbonate double glazing windows.

Acrylic and polycarbonate are porous therefore allowing gases including moisture to travel through them under certain conditions.

Non Standard Shaped Windows



'Half-moon' shape

Double glazing, safety glass, stainless steel framing
For custom shape windows and glazing options please consult manufacturer
Consult manufacturer for feasibility & price



Painting & Custom colours



Window frame custom colour
Additional detail paint
Frame painted different from leafs colour
Paint with structure surface
Non RAL colour
Metallic/Pearl finish RAL E2 (smooth surface only)

Panels painted more than one colour

£37 per window

£48 per detail

£64

£17 per sq. metre*

£12 per sq. metre*

£17 per sq. metre*

**Add to 'Custom colours' door price*

£426 per 1 extra colour



Custom colours on woodgrain & stucco surfaces:

Standard gloss 20%
Max gloss up to 40%
£50 per sq. metre



Custom colours on smooth surfaces:

Standard gloss 20%
Max gloss up to 40%
£60 per sq. metre



Same colour painted various parts may look unlike due to different basis material and surface structure.

Stainless Steel Threshold Cover



Luxury option - 1 mm thick brushed stainless steel threshold cover. Protects paintwork and significantly improves the look of garage door threshold. Suitable for cars. For S5 threshold only.

For door ≤ 2.5 m wide
For door > 2.5 m wide

£128
£256

Frame Architrave Mouldings



Only for doors fitted flush with the wall.
Close gap between wall and frame and save time and materials on decoration works.
Same colour as frame.

£200

SH2 Automation Kit



Fittings for door $W \leq 2800$
Fittings for door $W > 2800$
Reinforcement plates on door leaves included.
If ordered separately.

£179
£313
£45

Integrated Electromagnetic Latch



Compatible with antipanic lock and locks without outside handle. If activated - releases latch-bolt and allows to open the door. Can be activated by button, key code transmitter or remote handset.
Requires 24V DC power source (not included).

£101



Lockable ventilation grill (painted door colour)

£46

Steel Post



Rectangular tube with brackets, zinc coated & painted door colour.

Custom height up to 3 m to fit opening (please specify).

40x80 mm

40x100 mm

40x120 mm

£123

£141

£156

Side Fascia Panel



Matching infill for openings wider than 3000mm.

Made to measure. Height up to 2500 mm.

Matching door colour, layout & panel design.

Prices are for sandwich panels framed in alu profiles

Price per sq. metre

£246

Custom Shape Top Fascia Panel



Available for infills above door set that are not square.

Matching door colour, layout & panel design.

Price per sq. metre

£270

Integrated Letter Box



Convenience & energy saving option

Colour matched letter plate with lockable box inside door.

£230

Integrated Pet Flap



Convenience & energy saving option

Pet flaps available in various sizes - please consult manufacturer.

£166

Steel Appliques

All Ryterna doors can be enhanced with customised stainless steel or powder coated appliques. House numbers, company logos or favourite motif.

Price on request



Okoume Cladding

Okoume hardwood is extremely resistant to elements. 12 mm 18 mm plywood cladding gives unlimited possibilities to create classic and modern design doors.

Price on request



For more design possibilities please visit:
<http://www.ryternagaragedoors.co.uk/photo-gallery/>

Handing & Opening Options

SH2 Frame & Handing



Standard Frame *Options opening inside available*

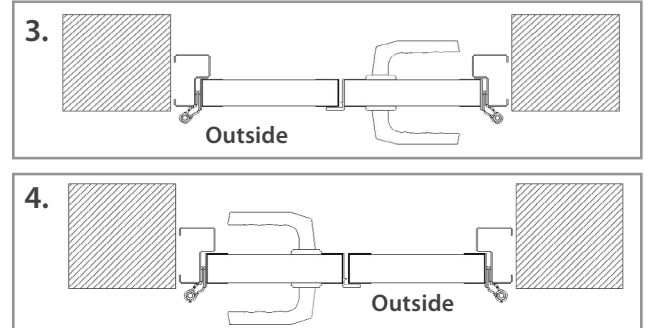
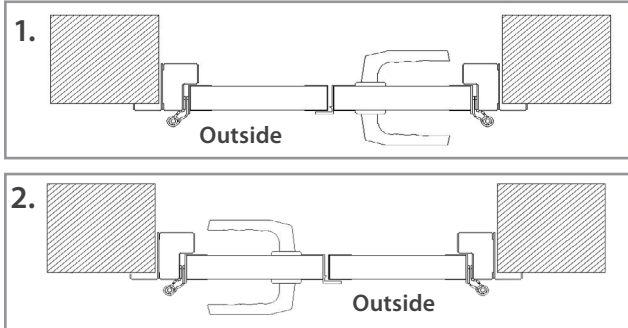

Tubular Frame *Options opening inside available*

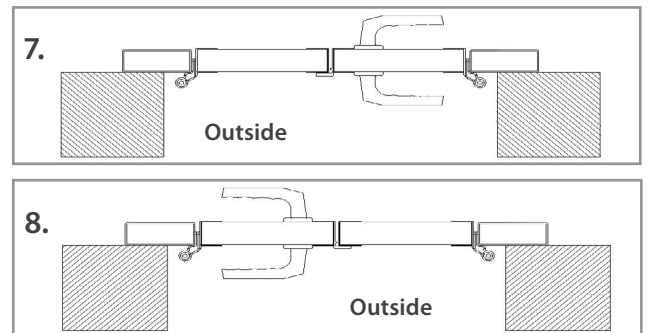
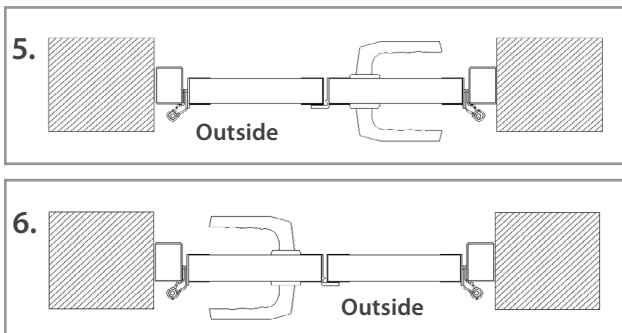

! Consult manufacturer for custom or non-standard technical solutions.

! Bi-folding leafs available. Consult for feasibility.
Add £959 per bifolding leaf on door price

! Standard SH2 split 50:50. please specify if non standard. Max door leaf width 1450 mm.



Handing & Opening Options

SH1 Frame & Handing

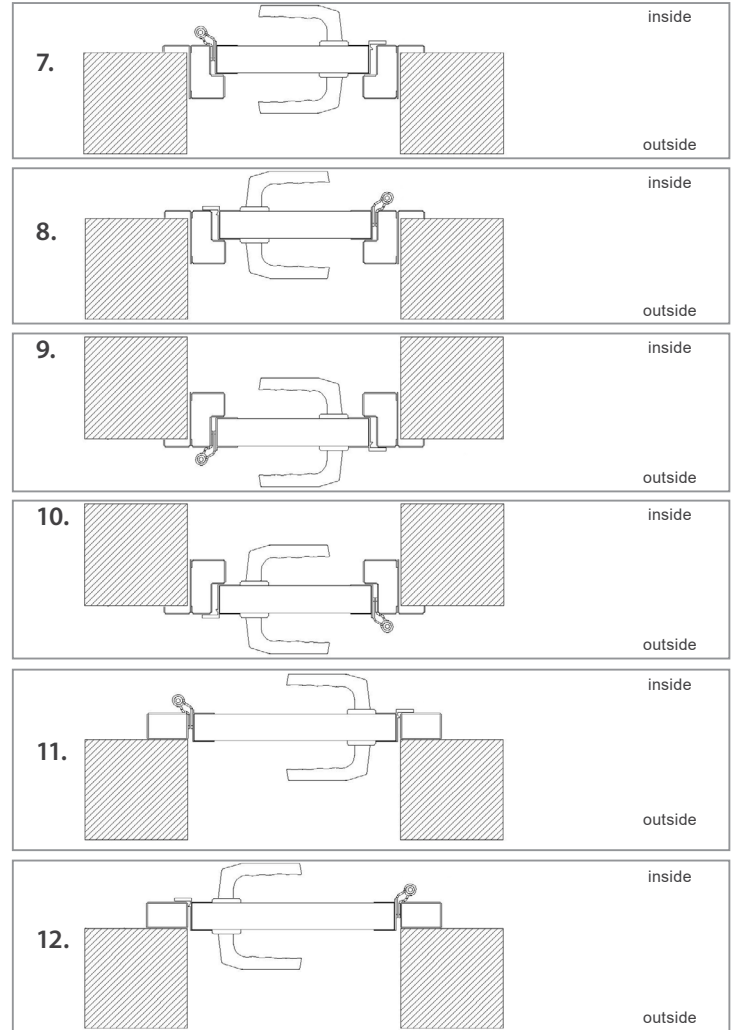
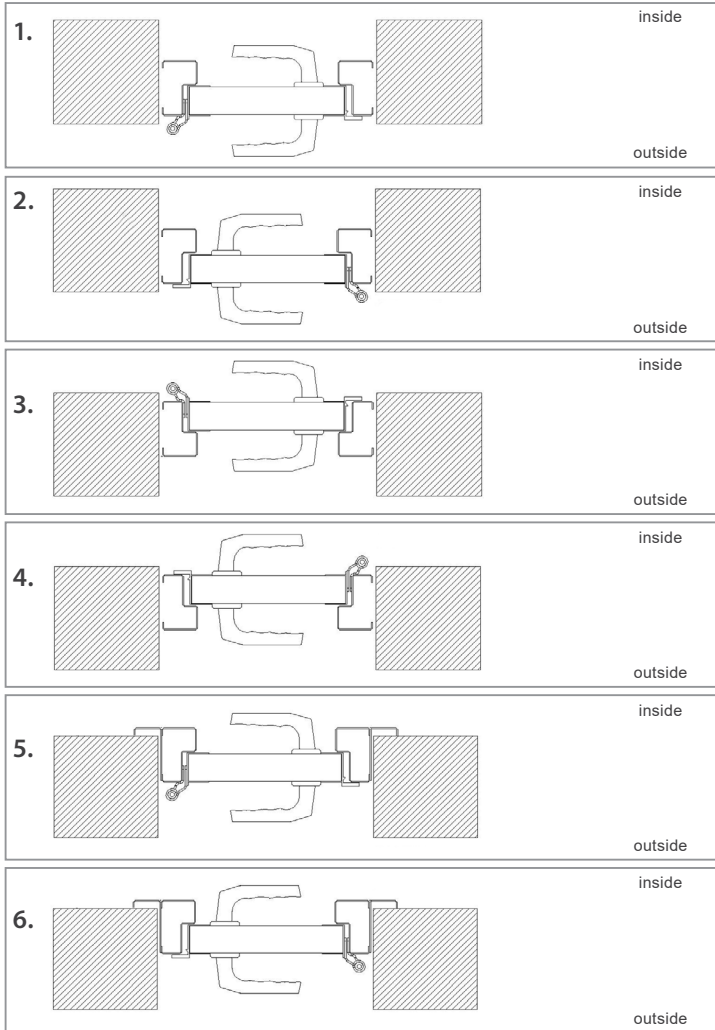

Site Survey Form

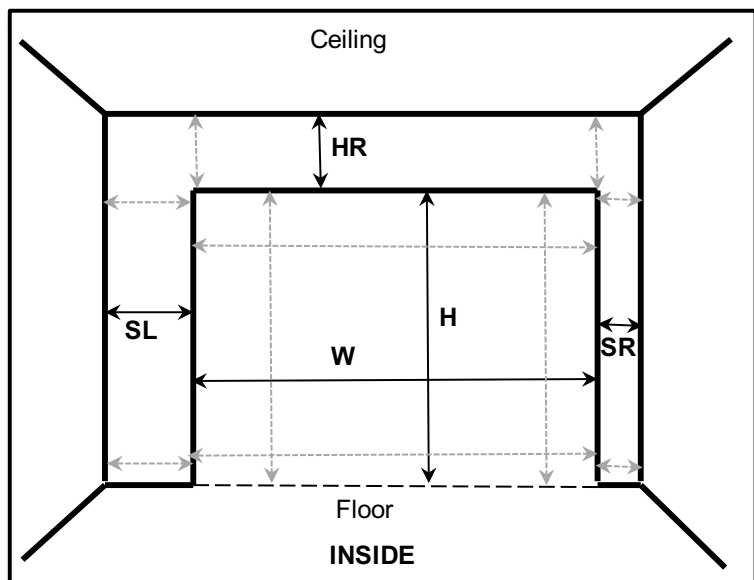

Aperture view

	(mm)	min	max
W	Width		
H	Height		
HR	Headroom		
SL	Sideroom left		
SR	Sideroom right		

For fitting Behind wall W and H must be measured on the inner side of wall. For fitting In between - W and H must be measured in fitting place.

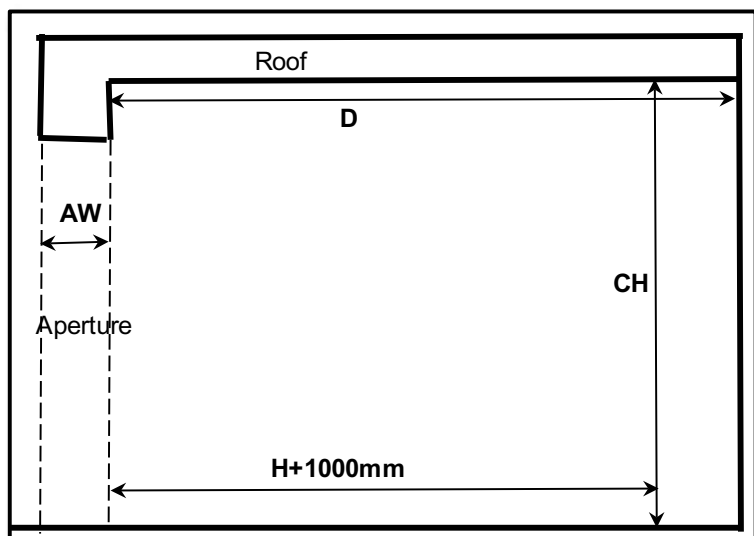

Side view

	(mm)**	min	max
D*	Depth		
CH**	Ceiling height		
AW	Wall thickness		

* **D** must be measured on top of lintel.

**** CH** must be measured on left and right sides of the garage.



Check for: a) windows and doors on side walls (position, height, opening direction); b) additional lintels on ceiling, columns, pillars on side walls; c) pipes and cables on HR, SL, SR wall; d) sloping driveway and ceiling; e) take in to account if floor is missing or existing floor level will be changed; f) check if surfaces on HR, SL, SR walls are level / plumb, floor is level.

Comments and additional drawings:





ORDER DATE:

DEALER:

ORDER REF.:

ORDER FORM FOR SINGLE LEAF (SH1) AND TWO LEAVES (SH2) DOORS

STEP 1 (write overall frame size)

 Width: mm
 Height: mm

STEP 2 (select panel layout and panel colour)

☐ Horizontal
☐ Vertical
☐ Chevron
☐ Traditional V
 with Rib panels
☐ Traditional H
 with Rib panels
 Panel Colour:
 Frame Colour:

STEP 3 (choose panel design and panel finish; tick 1 box)

Panel design	Panel Finish
Rib	<input type="checkbox"/> Woodgrain <input type="checkbox"/> Stucco <input type="checkbox"/> Wood Woodgrain
Midrib	<input type="checkbox"/> Woodgrain <input type="checkbox"/> Stucco <input type="checkbox"/> Wood Slick
Flush	<input type="checkbox"/> Woodgrain <input type="checkbox"/> Stucco <input type="checkbox"/> Slick+
Toprib	<input type="checkbox"/> Woodgrain <input type="checkbox"/> Slick
Georgian	<input type="checkbox"/> Woodgrain

For more in-depth information on our panels and colour finish options, please check our 'Pricelist 2017', pages 4-5

STEP 4 (choose external handle)

☐ Black
☐ White
☐ Aluminium
☐ Knob handle
☐ Anti-panic lock

STEP 5 (optional; choose additional parts)

☐ Door stays
☐ Espagnolette
☐ 3 point locking
☐ Ventilation grill
☐ Hinge bolts
☐ Key cylinder with thumb-turn

STEP 6 (optional; choose windows, amount of windows and windows glazing)

<input type="checkbox"/> Ø150 <input type="text"/> units <input type="checkbox"/> Ø230 <input type="text"/> units <input type="checkbox"/> Ø310 <input type="text"/> units	<input type="checkbox"/> 154x154 <input type="text"/> units <input type="checkbox"/> 230x230 <input type="text"/> units <input type="checkbox"/> 310x310 <input type="text"/> units
--	---

☐ 488x322 units residential
☐ 488x322 units "Sunrise"

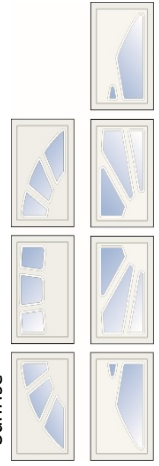
☐ 804x154 units

STEP 7 (choose threshold)

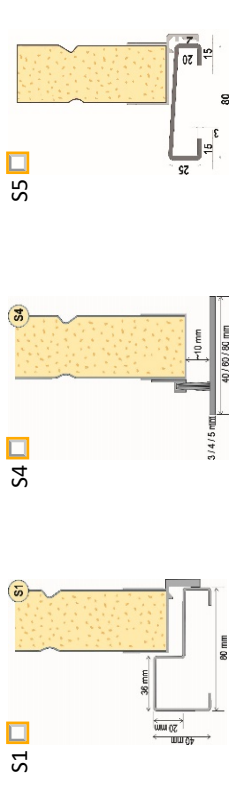

NOTE: not suitable for drive-through

NOTE: only with horizontal layout

NOTE: possible stainless steel option

STEP 8 (choose split)

☐ 50:50 (1/2 - 1/2) ☐ 30:70 (1/3 - 2/3)

STEP 9 (choose leaf and handing option)

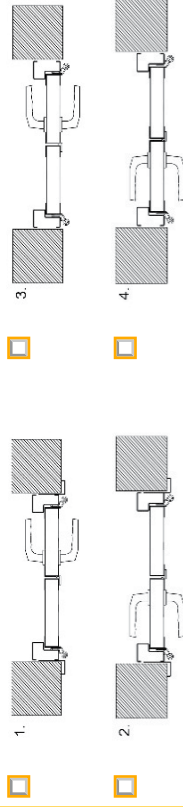

NOTE: Options 1-2 have frame mouldings

NOTE: All thresholds are suitable for options 1-4

STEP 10 (comments, requests)

☐ FV panel "Cross"

☐ FV-BS panel

Window or FV glazing options:

☐ Clear ☐ Frosted ☐ Matt ☐ Tinted
Window or FV frame colour: (leave blank if no colour is required)

CONSULT MANUFACTURER FOR ADDITIONAL OPTIONS AND/OR MODIFICATIONS.

Clear All

Print Order

Submit Order

[illegible]

